

# BACKRESTS

## POSITIONING



Physipro™ Backrests

Lateral Supports

Postural Components

Covers

Accessories



**PHYSIPRO®**  
Seating and mobility solutions

# TABLE OF CONTENT

4 to  
15

PHYSIPRO™ BACKRESTS

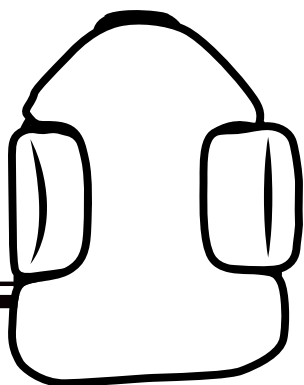

16 to  
23

LATERAL SUPPORTS

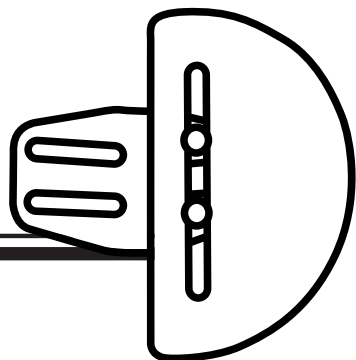

24 to  
27

POSTURAL  
COMPONENTS

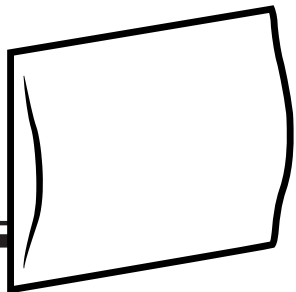

28 to  
31

COVERS

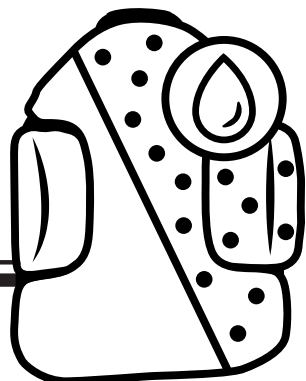

32 to  
35

ACCESSORIES

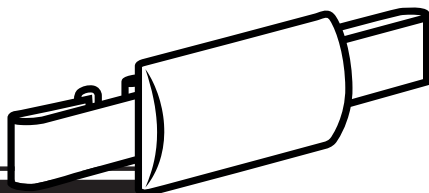





# PHYSIPRO™ BACKRESTS





The Axis® tension adjustable backrest offers superior back support and comfort. Characterized by its unilateral strap system, the Axis® backrest conveniently enables continuous and precise adjustments in order to ensure better support for individuals with progressive chronic diseases.

TECHNICAL SPECIFICATIONS	
Retail Price from	\$300
Product Code	Standard : D5209 With Velcro : D5211
Product Type	Tension adjustable backrest
Width	10" to 24"
Height	12" to 24"
Thickness	1"
Weight	1,9 lb (17" x 20")
COMPOSITION	
Cushioning	1" Urethane
Straps	Nylon
Mounting system	Screws and «One Wrap» Velcro straps
OPTIONS	
Lateral supports	Fixed to the wheelchair canes, Anti-Hammock Effect, Adjustable or Foldable
Cushioning	½" or 1" Urethane, ½" or 1" Viscose, 1" Stimulite, ½" or 1" Soft memory foam, ½" to 1" Temper T36, 1" Latex and ¼" Plastazote
Accessories	Booster cushion, lumbar strap, lumbar and thoracolumbar system and tension bar.
Postural components	Thoracic wedge, lumbar wedge, thoracolumbar wedge and sacrolumbar corrector
COVERS	
Outer cover	Basic cover
Incontinence cover	Transparent cover with velcro



**UNIFORM DISTRIBUTION**  
of pressure and weight



**EASE OF INSTALLATION AND CARE**



**COMPENSATES BASIC & COMPLEX POSTURAL DEVIATION**



**EFFICIENT LUMBAR SUPPORT**



**EASILY ADAPTS**  
to changing postural needs

EASE OF INSTALLATION 9 / 10

PRECISION ADJUSTMENT 7 / 10

COMFORT 8 / 10

POSTURE CORRECTION 7 / 10

By its design and simple and effective adjustment system, the Axis® backrest adapts to the shape of the user's back and can be easily adjusted to accommodate different pathologies. The straps of the Axis® are equipped with Velcro bands that permit easy adjustments of the backrest tension.

**SIMPLE AND PRECISE ADJUSTMENTS**



**SUPERIOR COMFORT** The standard Axis® backrest is cushioned with a layer of urethane, Physipro™ offers additional cushioning options for users who require a deeper immersion.

Installed in the lumbar region, this system helps to correct an anterior pelvic tilt or, if needed, maximises the support surface in cases of lordosis. Installed at the thoracic region, this system creates a forward projection in order to obtain a kyphotic profile.

**LUMBAR AND THORACOLUMBAR SYSTEM**

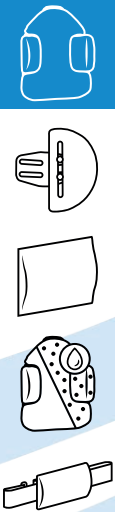





Comfortable, lightweight, durable and easy to use, The Premium™ ensures complete bilateral control of the posterior and anterior curvatures of the spine, providing the ideal back support.

TECHNICAL SPECIFICATIONS

Retail price from	\$300
Product code	Standard: D5200 With velcro: D5440
With velcro: D5440	Dossier à tension réglable
Product type	Tension adjustable backrest
Width	12" to 26"
Height	12" to 26"
Thickness	1"
Weight	2,8 lbs (17" x 20")

COMPOSITION

Cushioning	1" Urethane
Straps	Nylon
Mounting system	Screws, straps and autoblock buckles

OPTIONS

Lateral supports	Fixed to the wheelchair canes, Anti-Hammock Effect, Adjustable or Foldable
Cushioning	½" or 1" Urethane, ½" or 1" Viscose, 1" Stimulite, ½" or 1" Soft memory foam, ½" to 1" Temper T36, 1" Latex and ¼" Plastazote
Accessories	Lumbar strap, booster cushion and tension bar.
Postural components	Thoracic wedge, lumbar wedge, thoracolumbar wedge and sacrolumbar corrector

COVERS

Outer cover	Basic cover
Incontinence cover	Transparent cover with velcro
Back post covers	With or without zipper



UNIFORM DISTRIBUTION of pressure and weight

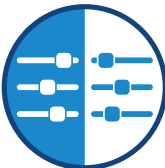

BILATERAL CONTROL OF THE BACK SUPPORT



SUPERIOR PRECISION ADJUSTMENT



COMPENSATES BASIC & COMPLEX POSTURAL DEVIATION

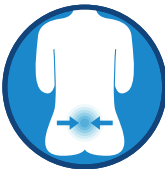

EFFICIENT LUMBAR SUPPORT

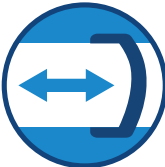

EASILY ADAPTS to changing postural needs

Offered as an option, back post covers simplify the installation of the Premium™ backrest to the wheelchair. These zippered covers allow you to instantly envelop the back posts, protecting the user against direct contact with their hard surface while also permitting quick installation of lateral supports if needed.

QUICK AND EASY INSTALLATION

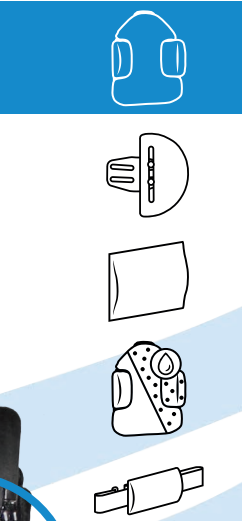

The various straps of the Premium™ permit the user to easily modify and adapt the backrest to provide better back support in cases of kyphosis, lordosis, pelvic rotation and gibbosity. Equipped with autoblocking buckles, that are easily fastened or unfastened, the 1-inch straps maintain a durable and stable tension over the full length of the backrest.

SIMPLE AND DURABLE ADJUSTMENTS

EASE OF INSTALLATION 7 / 10

PRECISION ADJUSTMENT 9 / 10

COMFORT 9 / 10

POSTURE CORRECTION 9 / 10





The Valdis™ is a soft sling backrest designed to offer optimal comfort by adapting to the curves of the back. Capable of adapting to diverse morphologies, the Valdis™ is particularly recommended for people with Hyperkyphosis.

TECHNICAL SPECIFICATIONS	
Retail price from	\$300
Product code	D5250
Product type	Tension adjustable backrest
Width	14" to 24"
Height	14" to 24"
Thickness	1 ½"
Weight	4,98 lbs (16" x 20")

COMPOSITION	
Cushioning	1 ½" Square-patterned Urethane
Straps	Nylon
Mounting system	Screws and Zippered Back Post Cover

OPTIONS	
Lateral supports	Fixed to the wheelchair canes, Adjustable or Foldable
Accessories	Tension bar

COVERS	
Outer cover	Basic cover
Incontinence cover	Transparent cover with velcro



**UNIFORM DISTRIBUTION**  
of pressure and weight



**SUPERIOR IMMERSION**  
of deformities, gibbosities or severe kyphosis



**EFFICIENT LUMBAR SUPPORT**

**QUICK AND EASY INSTALLATION**

The combination of Velcro fasteners and the zippered back post covers maintain the back cushion in place, effectively limiting movement inside the cover and preventing the cushion from sliding on the back posts. The cushioned back of the Valdis™ can be easily removed from the cover to facilitate cleaning.

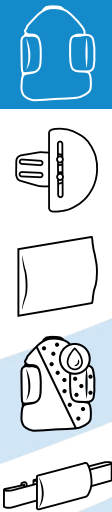

The cushioned back of the Valdis™ is cut with precision in order to provide a deeper immersion. With a square-patterned cut that increases the cushions flexibility and suppleness, the Valdis™ offers optimal pressure distribution.

**DEEPER IMMERSION**

The high elasticity of the fabric and the straps of the Valdis™ allows a deeper immersion and helps create an adapted back support that is fitted to the user's specific postural structure. The presence of three adjustment straps at the lower back offers efficient support at the lumbar region and the addition of lateral supports increases trunk stability and balance.

**COMPLETE SUPPORT**

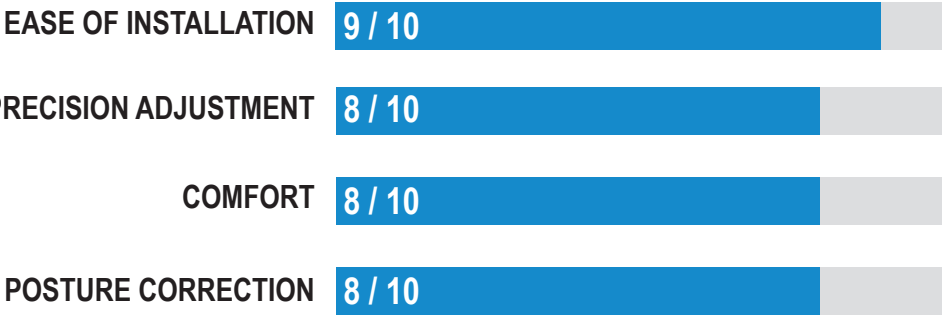



# VELCRO BACK

Comfortable and lightweight, the Velcro Back is a soft and versatile postural aid, developed for persons with problems relating to core stability, this backrest can be fitted with various detachable lateral supports.

## TECHNICAL SPECIFICATIONS

Retail price from	\$170
Product code	D4060 (14" x 16") D4065 (16" x 16") D4070 (18" x 16")
Product type	Tension adjustable backrest
Width	14", 16" or 18"
Height	16"
Thickness	1/16"
Weight	0,6 lb

## COMPOSITION

Mounting system	Nylon straps with velcro and plastic buckles
Cushioning	Velcro Loop Fabric and Lycra (Ribbed Spandex)

## OPTIONS

Lateral supports	Elevated, Shaped or Anti-hammock effect
Accessories	Booster Cushion



**SUPPORTS BASIC POSTURAL DEVIATIONS**



**EASY INSTALLATION AND MAINTENANCE**



**IMPROVES CORE STABILITY AND POSTURE**

The Velcro Back adapts to the width of the wheelchair and is attached directly to the back posts with three 1½" adjustable nylon straps. Each strap is equipped with Velcro and a sturdy plastic buckle to ensure backrest tension is consistently maintained and that the backrest is held at the proper height.

## QUICK AND EASY INSTALLATION



EASE OF INSTALLATION 9 / 10

PRECISION ADJUSTMENT 6 / 10

COMFORT 5 / 10

POSTURE CORRECTION 6 / 10





The HP2™ backrest line was designed with high performance and precision in mind. Characterised by a rigid shell that encompasses the user's back to provide overall lateral and central support, this backrest was created for persons with significant postural asymmetries

## TECHNICAL SPECIFICATIONS

Retail price from	\$822
Product code	Profiled: HPP Contour: HPC
Product type	Rigid contoured shell
Width	12" to 24"
Height	12" to 24"
Thickness	1 ¾"
Weight	7,4 lbs (16" x 18" - without lateral supports) 8,8 lbs (16" x 18" - with lateral supports)

## COMPOSITION

Cushioning	¼" Plastazote, ½" Soft memory foam and 1" Viscose
Mounting system	Two-point mounting system (with quick release)
Shell	1¾" Aluminum

## OPTIONS

Lateral supports	Contour, Adjustable or Foldable
Cushioning	½" or 1" Urethane, ½" or 1" Viscose, 1" Stimulite, ½" or 1" Soft-memory foam, ½" to 1" Temper T36, 1" Latex and ¼" Plastazote
Accessories	Harness
Postural components	Thoracic wedge, lumbar wedge, thoracolumbar wedge and sacrolumbar corrector

## COVERS

Outer cover	Basic cover with or without cut out for harness
Incontinence cover	Transparent cover with velcro



**UNIFORM DISTRIBUTION**  
of pressure and weight



**IMPROVES STABILITY AND POSTURE**



**REDUCES SLIDING AND LIMITS SPASTICITY**



**ENCOMPASSES BASIC & COMPLEX POSTURAL DEVIATION**



**INCREASES OVERALL SUPPORT OF THE BACK**

## A UNIQUE MOUNTING SYSTEM

The HP2™ can be quickly installed or removed from the back post in one easy movement. Designed with a backrest inclination range from 0° to 40°, this feature ensures an optimal sitting position.



The ergonomic shape of the HP2™ Profiled provides a greater liberty of movement of the upper limbs and facilitates manual propulsion. The lateral supports of the HP2™ Profiled can be adjusted both vertically and laterally as well as tilted to the desired angle in order to obtain enough space around the shoulder blades (to easily operate the handrims) and provide the highest level of comfort.

The HP2™ Contour offers improved overall back support. Ideal for persons who require additional trunk support.

## TWO AVAILABLE MODELS

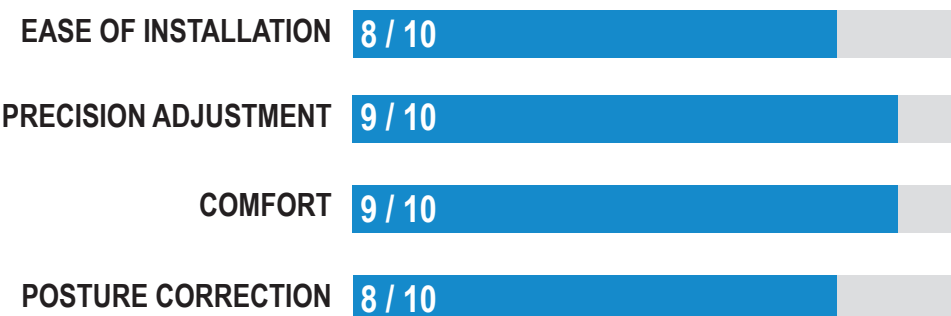



# LATERAL SUPPORTS

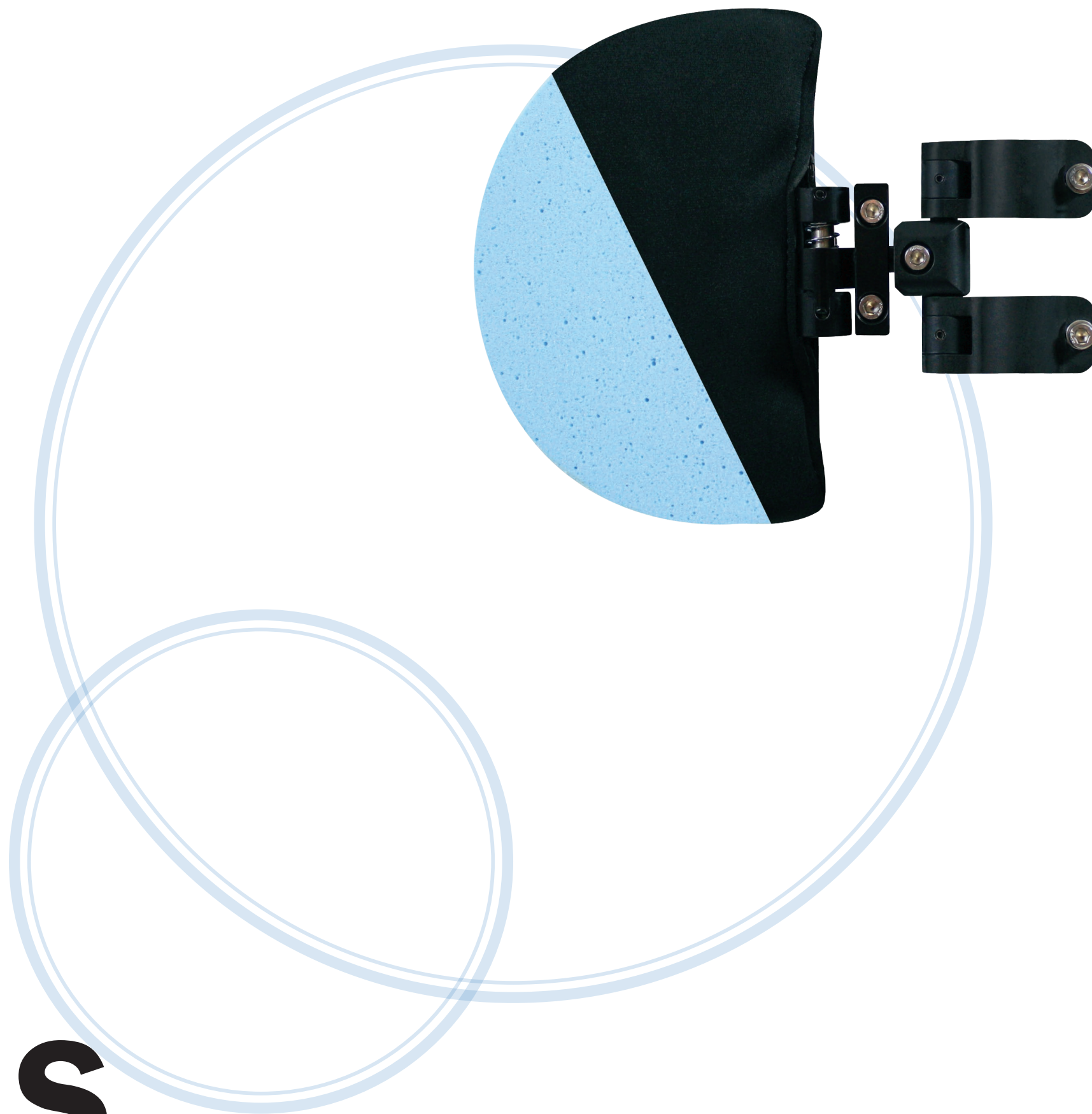

# FIXED TO THE WHEELCHAIR BACK POST

Fixed lateral supports provide the assistance needed to properly stabilize and balance the torso. The fixed lateral hardware allows a full 360-degree rotation of the lateral supports and are height-adjustable. Once secured to the back post, the mounting hardware diminishes the need of readjustment and increases durability.

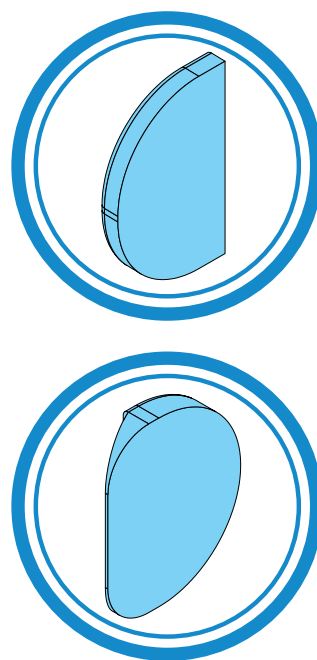
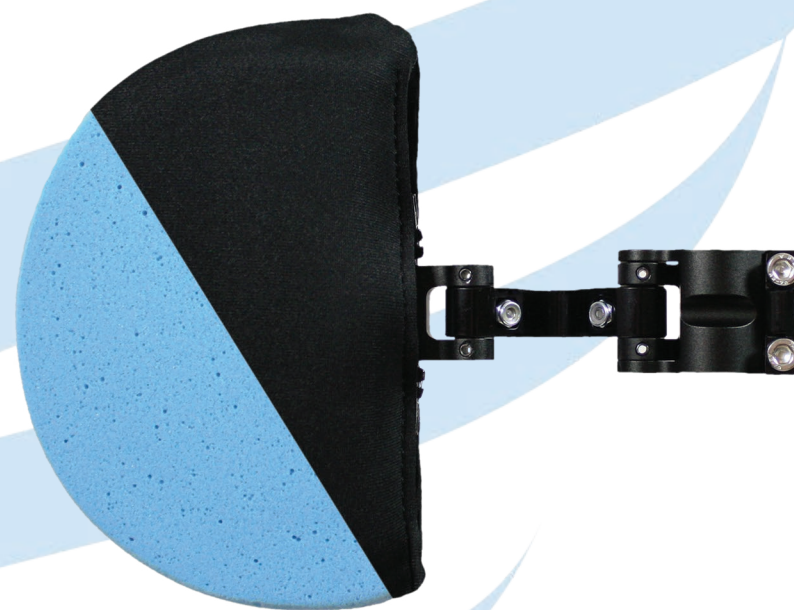

## LATERAL SUPPORTS SPECIFICATIONS

Product Code	See order forms or product catalog
Dimension (H x D)	4" x 4", 6" x 4 1/2", 7" x 4 1/2", 8" x 4 1/2",
Thickness	1 1/4"
Hardware Composition	Aluminum
Installation	Fixed on 3/4" or 1" tubing
Height-adjustment	Full-length of back post
Depth-adjustment	3/4"
Width between the laterals	Min: width of backrest -8" Max: width of backrest -3"
Inclination	360°

## PADDING SPECIFICATIONS

Pad options	Straight or Profiled
Pad composition	1" Soft memory foam and 1/4" Plastazote

## COVERS

Outer cover	1/16" Neoprene
-------------	----------------

# CONTOUR

With the soft curved design and a composition of plastazote and urethane, the Contour laterals provide optimal stability and support. Available with the HP2 Contour only, the aluminum structure is fixed directly onto the rigid shell of the backrest.



## LATERAL SUPPORTS SPECIFICATIONS

Product Code	See order forms or product catalog
Dimension (H x D)	7" x 6", 7" x 7", 8" x 6", 8" x 7", 9" x 6" or 9" x 7"
Thickness	Determined by backrest foam choices
Hardware Composition	Aluminum
Installation	Fixed to the rigid shell of backrest
Height-adjustment	1 1/2"
Depth-adjustment	N/A
Width between the laterals	Width of backrest -5"

## PADDING SPECIFICATIONS

Pad composition	1/4" Plastazote and 1/2" Urethane
-----------------	-----------------------------------

## COVERS

Outer cover	1/16" Neoprene
-------------	----------------

Note\*\* Only available with the HP2 Contour Backrest.





# ADJUSTABLE

Adjustable lateral supports improve trunk and core alignment and help ensure a balanced distribution of pressure over the backrest surface. These adjustable supports can be easily removed if necessary and can be used unilaterally.

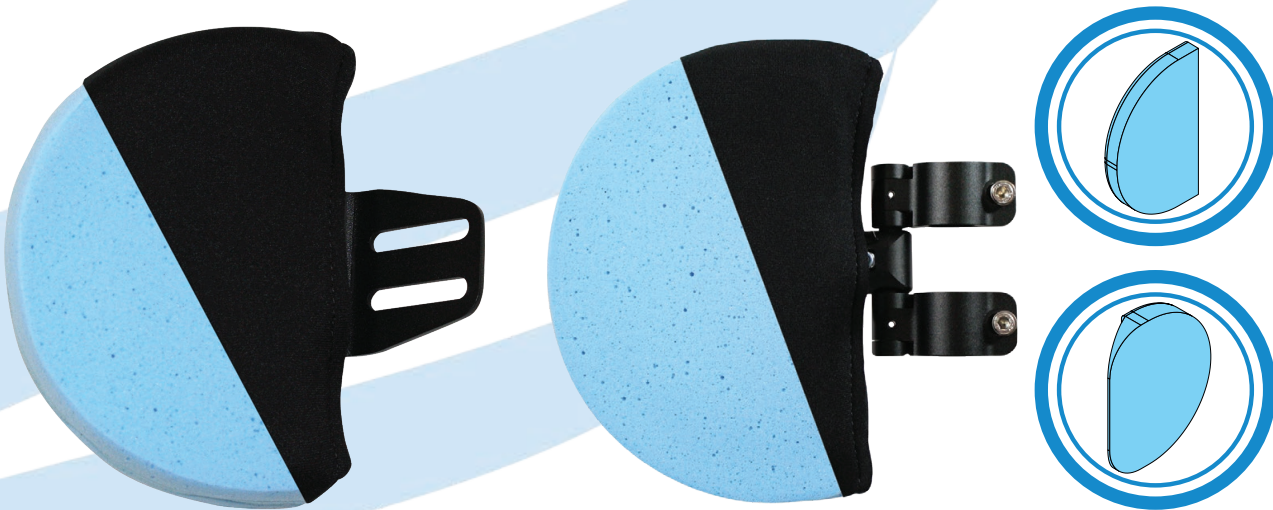

## LATERAL SUPPORTS SPECIFICATIONS

Specification	For Rigid Back	For Sling Back
Product Code	See order forms or product catalog	See order forms or product catalog
Dimension (H x D)	4" x 4", 6" x 4 1/2", 7" x 4 1/2", 8" x 4 1/2", 8" x 5 1/2", 10" x 4 1/2" or 10" x 5 1/2"	6" x 4 1/2", 7" x 4 1/2", 8" x 4 1/2", 8" x 5 1/2", 10" x 4 1/2" or 10" x 5 1/2"
Hardware Composition	Aluminum	Aluminum
Installation	Fixed to the rigid shell of backrest	Fixed on 3/4" or 1" tubing
Height-adjustment	4" x 4": N/A 6" x 4 1/2": 1" 7" x 4 1/2": 1" 8" x 4 1/2": 1 1/2" 8" x 5 1/2": 1 1/2" 10" x 4 1/2": 3" 10" x 5 1/2": 3"	Full-length of back post
Depth-adjustment	1 3/4"	3/4"
Width between the laterals	Min: width of backrest -5" Max: width of backrest -3"	Min: width of backrest -4" Max: width of backrest -2"

## PADDING SPECIFICATIONS

Pad options	Straight or Profiled	Straight or Profiled
Pad composition	1" Soft memory foam and 1/4" Plastazote	1" Soft memory foam and 1/4" Plastazote

## COVERS

Outer cover	1/16" Neoprene	1/16" Neoprene
-------------	----------------	----------------

# FOLDABLE AND ADJUSTABLE

The foldable and adjustable lateral supports facilitate transfers by enabling the lateral supports to be moved aside with a pivoting mechanism.



## LATERAL SUPPORTS SPECIFICATIONS

Specification	For Rigid Back	For Sling Back
Product Code	See order forms or product catalog	See order forms or product catalog
Dimension (H x D)	4" x 4", 6" x 4 1/2", 7" x 4 1/2", 8" x 4 1/2", 8" x 5 1/2", 10" x 4 1/2" or 10" x 5 1/2"	6" x 4 1/2", 7" x 4 1/2", 8" x 4 1/2", 8" x 5 1/2", 10" x 4 1/2" or 10" x 5 1/2"
Hardware Composition	Aluminum	Aluminum
Installation	Fixed to the rigid shell of backrest	Fixed on 3/4" or 1" tubing
Height-adjustment	4" x 4": N/A 6" x 4 1/2": 1" 7" x 4 1/2": 1" 8" x 4 1/2": 1 1/2" 8" x 5 1/2": 1 1/2" 10" x 4 1/2": 3" 10" x 5 1/2": 3"	Full-length of back post
Depth-adjustment	1 3/4"	3/4"
Width between the laterals	Min: width of backrest -5" Max: width of backrest -3"	Min: width of backrest -4" Max: width of backrest -2"
Foldable	Yes	Yes

## PADDING SPECIFICATIONS

Pad options	Straight or Profiled	Straight or Profiled
Pad composition	1" Soft memory foam and 1/4" Plastazote	1" Soft memory foam and 1/4" Plastazote

## COVERS

Outer cover	1/16" Neoprene	1/16" Neoprene
-------------	----------------	----------------



# ELEVATED

Installed low on the backrest, with Velcro for precise positioning, the peculiar shape of these laterals offers optimal upper torso support and ensures liberty of movement of the upper limbs. The elevated lateral supports were designed to increase stability and balance and ensure proper alignment of the torso. Available with the Velcro fabric backrest only.

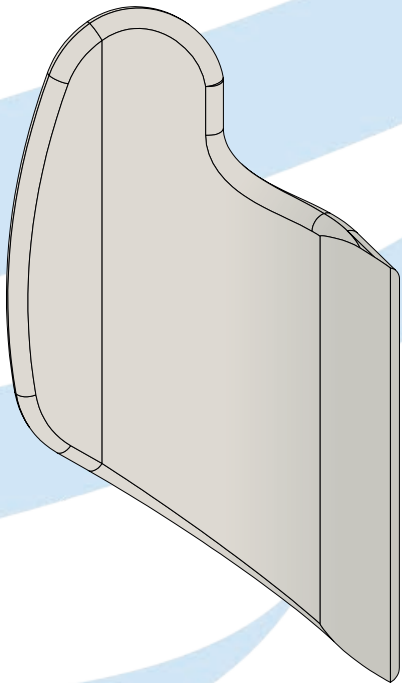

## LATERAL SUPPORTS SPECIFICATIONS

Product Code	See order forms or product catalog
Dimension (W x H x D)	5" x 9 1/2" x 4 1/2", 5" x 12" x 5 1/2", 6" x 14 1/2" x 6 1/2", 6" x 14 1/2" x 7 1/2"
Thickness	1 1/2"
Composition	1" Ethafoam and 1/2" Urethane
Installation	Fixed with velcro
Height-adjustment	Full-length of backrest
Depth-adjustment	N/A
Width between the laterals	Min: 9" Max: width of backrest - 3"

## COVERS

Outer cover	Startex RR and Oxford
-------------	-----------------------

Note\*\* Only available with the Velcro Back.

# SHAPED

Providing superior comfort, the shaped laterals increases the support surface and help improve overall pressure distribution by encompassing the user's back. Installed with a Velcro fastening system, these laterals can be accurately placed on the backrest to improve balance and posture and help control lateral trunk movement.

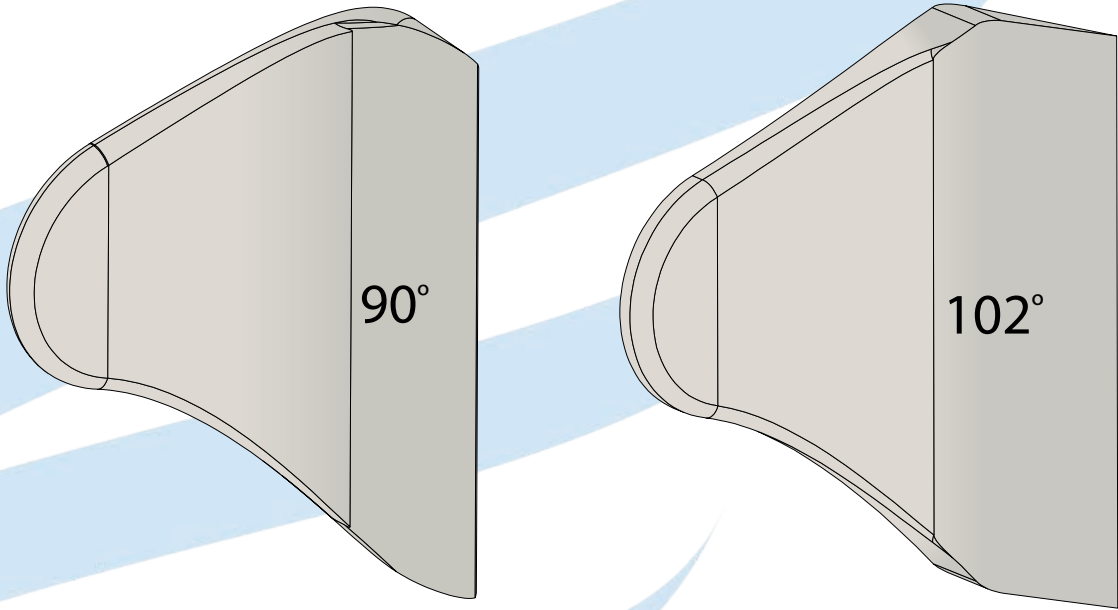

## LATERAL SUPPORTS SPECIFICATIONS

Specification	Basic Shaped	Basic Shaped (Anti-Hammock Effect )
Product Code	See order forms or product catalog	See order forms or product catalog
Dimension (W x H x D)	6" x 14 1/2" x 5 1/2", 6" x 14 1/2" x 6 1/2"	6" x 14 1/2" x 5 1/2", 6" x 14 1/2" x 6 1/2"
Thickness	1 1/2"	1 1/2"
Composition	1" Ethafoam and 1/2" Urethane	1" Ethafoam and 1/2" Urethane
Installation	Fixed with velcro	Fixed with velcro
Height-adjustment	Min: 12" (to the apex) Max : Height of backrest -3"	Min: 12" (to the apex) Max : Height of backrest -3"
Depth-adjustment	N/A	N/A
Width between the laterals	Min: 10" Max: Width of backrest -3"	Min: 10" Max: Width of backrest -3"

## COVERS

Outer cover	Startex RR and Oxford	1/16" Neoprene
-------------	-----------------------	----------------





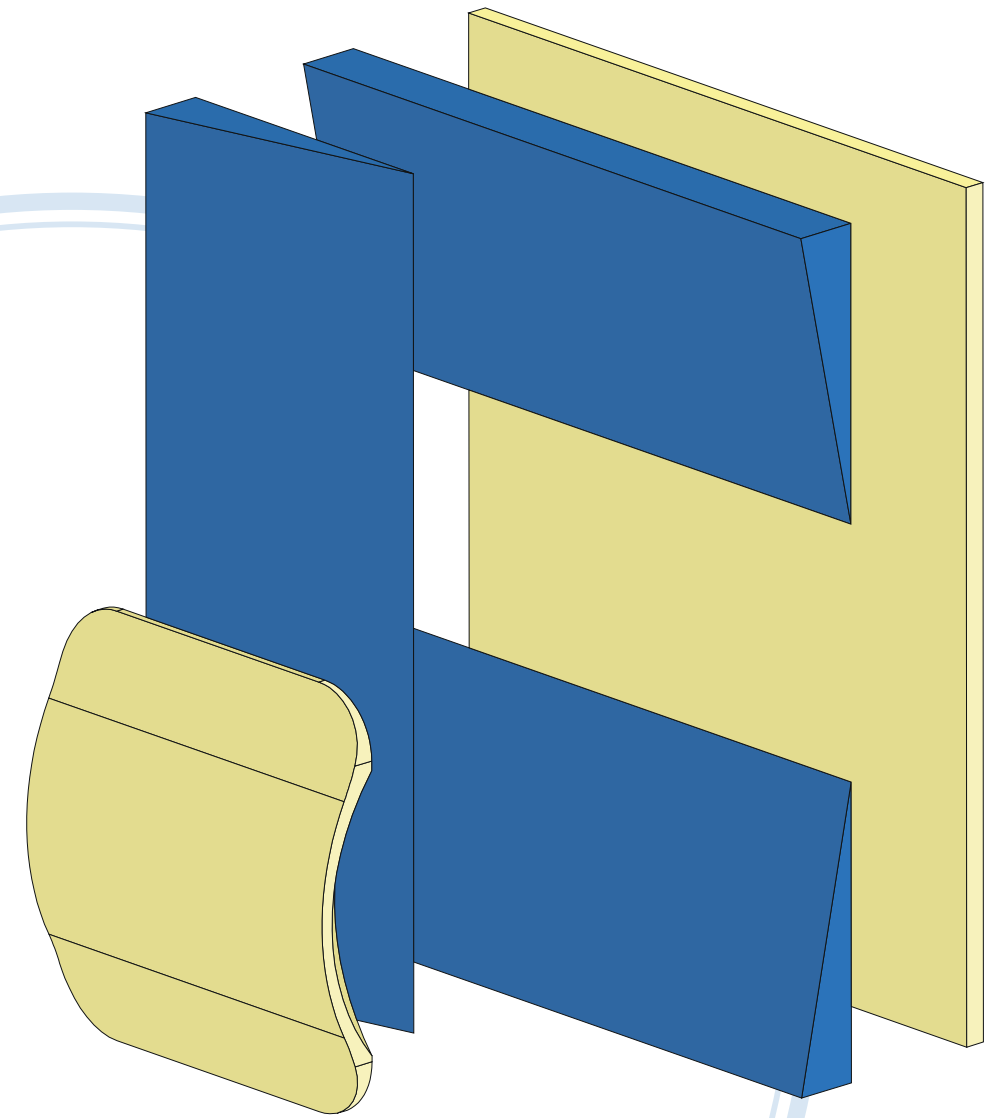

# POSTURAL COMPONENTS

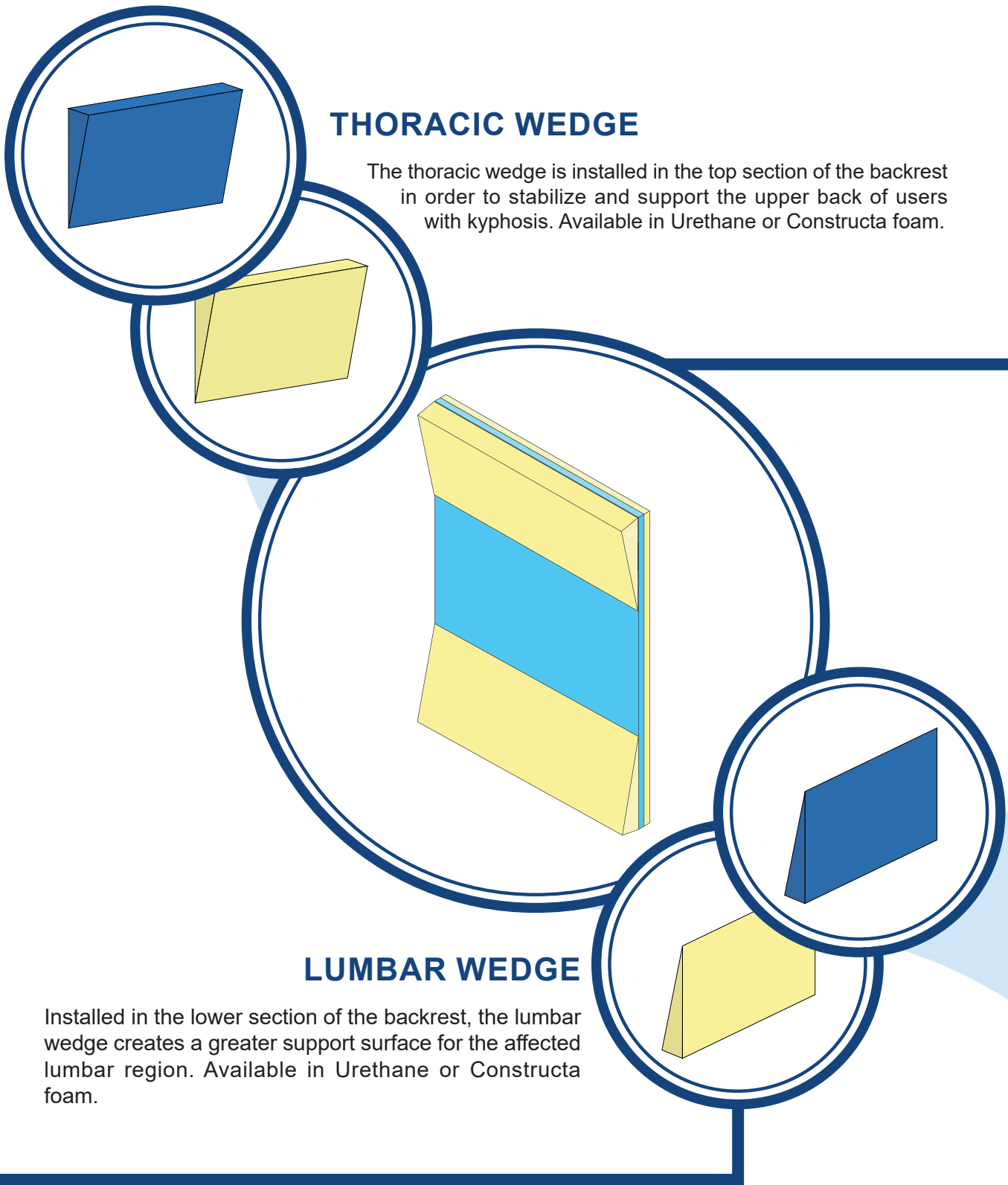

TECHNICAL SPECIFICATIONS (THORACIC WEDGE)	
Product code for Constructa foam wedge	D3380-...
Product code for Urethane wedge	D3385-...
Height - Width	Adapted to backrest
Thickness	1", 1 ½" or 2"
Installation	Velcro or glued
Cover	Available with velcro installation only

TECHNICAL SPECIFICATIONS (LUMBAR WEDGE)	
Product code for Constructa foam wedge	D3400-...
Product code for Urethane wedge	D3405-...
Height - Width	Adapted to backrest
Thickness	1", 1 ½" or 2"
Installation	Velcro or glued
Cover	Available with velcro installation only

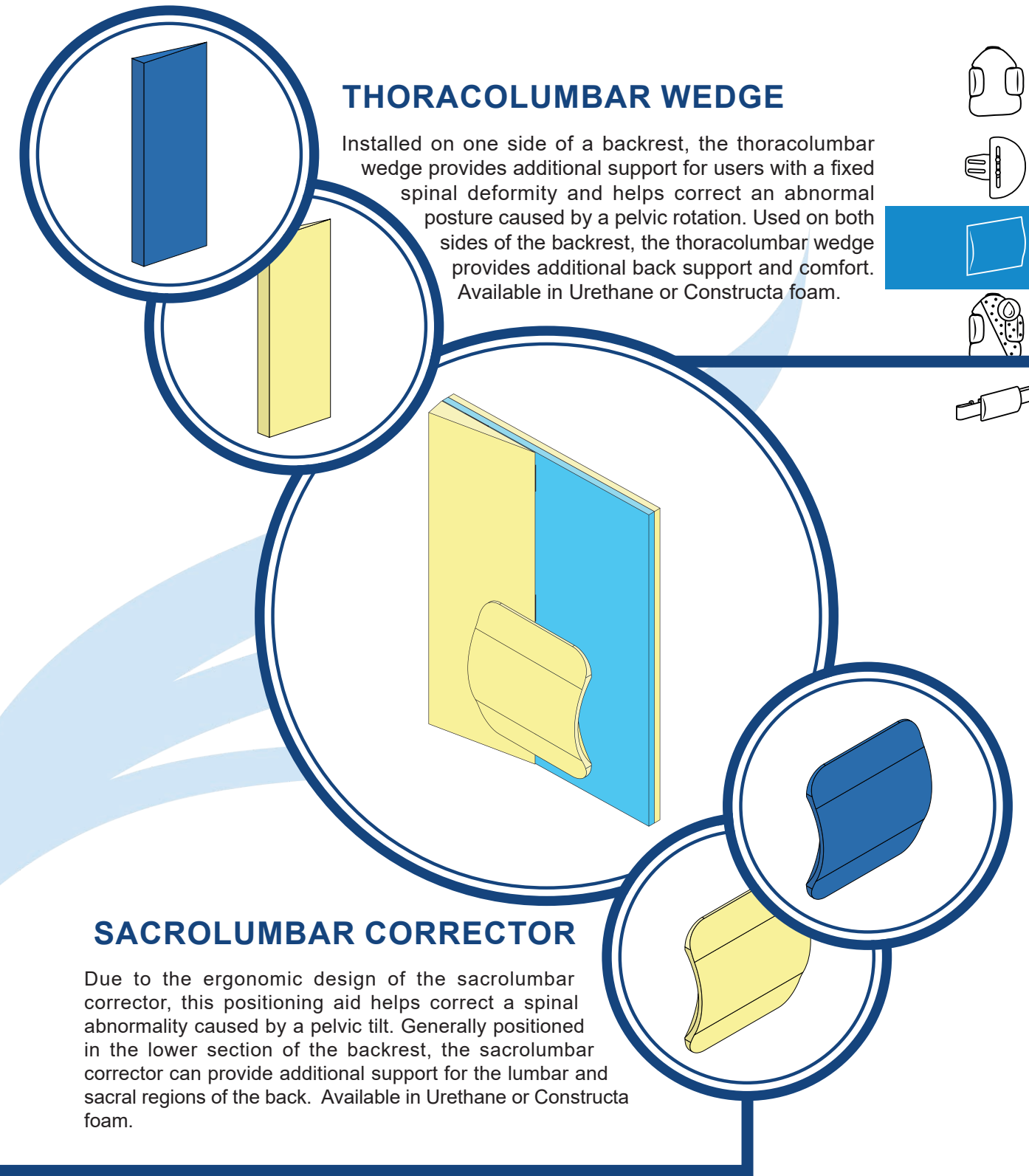

TECHNICAL SPECIFICATIONS (THORACOLUMBAR WEDGE)	
Product code for Constructa foam wedge	D3390-...
Product code for Urethane wedge	D3395-...
Height - Width	Adapted to backrest
Thickness	1", 1 ½" or 2"
Installation	Velcro or glued
Cover	Available with velcro installation only

TECHNICAL SPECIFICATIONS (SACROLUMBAR CORRECTOR)	
Product code	Varies depending on dimension and composition
Dimensions (W X H X T) for Constructa foam Sacrolumbar corrector	9 ½" x 10" x 1" (D3425) 9 ½" x 11" x 1 ½" (D3430) 9 ½" x 12" x 2" (D3435)
Dimensions (W X H X T) for Urethane Sacrolumbar corrector	9 ½" x 10" x 1" (D3410) 9 ½" x 11" x 1 ½" (D3415) 9 ½" x 12" x 2" (D3420)
Installation	Velcro or glued
Cover	Available with velcro installation only



# COVERS



# COVERS



### COVER FOR ADJUSTABLE TENSION BACKREST

Improves heat and moisture transfer, permits the installation of various postural components and eliminates surface tension.



VENTILATION



### COVER FOR RIGID BACKREST

Improves heat and moisture transfer and comes with a handle for easy transport. Headrest and harness cut-out options are available.



VENTILATION



### COVER WITH VELCRO SURFACE

Anti-hammock effect lateral supports and postural components with covers can be installed directly onto the Velcro surface, facilitating precise and quick adjustments.



EASY-TO-USE



### INCONTINENCE COVER

Simple and efficient, protects the backrest with a fine layer of waterproof plastic fabric and sealed with Velcro.



EASY MAINTENANCE



### COVERS

Backrest	Cover for adjustable tension backrest	Cover for rigid backrest	Incontinence cover
Axis®	D5214	N/A	PD50715
Premium™	D5201	N/A	PD50715
Valdis™	D5251	N/A	PD50715
Toile Velcro	N/A	N/A	N/A
HP2™	N/A	HP1C – Air Knit Cover D5212 - Lycra Cover HP1 - Standard Cutout for headrest support HP2 - Cutout for harness	PD50715



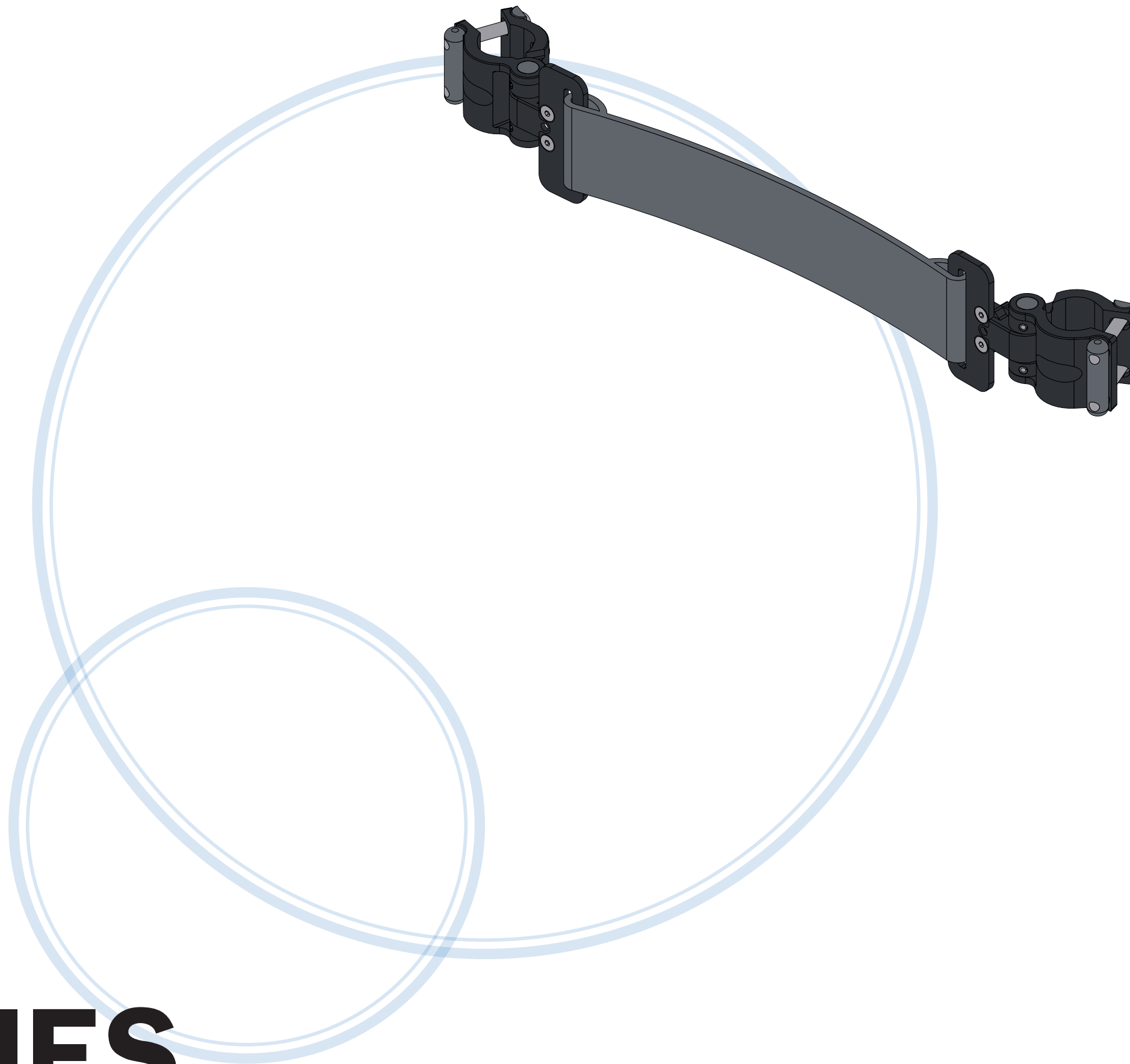

# ACCESSORIES

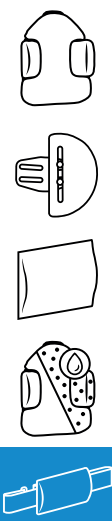

BOOSTER CUSHION

The booster cushion is inserted between the anti-hammock effect lateral supports and secured with velcro, creating a smooth and uniform surface that maximises comfort.

TECHNICAL SPECIFICATIONS	
Product code	12" width: D4045 14" width: D4050
Composition	½" Urethane
Width	12" or 14"
Height	Adapted to backrest

LUMBAR AND THORACOLUMBAR SYSTEM

The lumbar and thoracic support system is equipped with an adjustable strap and two mounting clamps that permit easy installation and positioning on any sling backrest, regardless of width. Installed at the lumbar region, this system helps correct an anterior pelvic tilt or maximises contact of the support surface in cases of lordosis. Installed at the thoracic region, this system creates a forward projection in order to obtain a kyphotic profile.

TECHNICAL SPECIFICATIONS	
Product code	D38699
Composition	Clamp mounting system, metal anchor plates and strap
Width	Adjusted with velcro to fit the width of backrest
Height	2"
Installation	Fixed on ¾" or 1" tubing

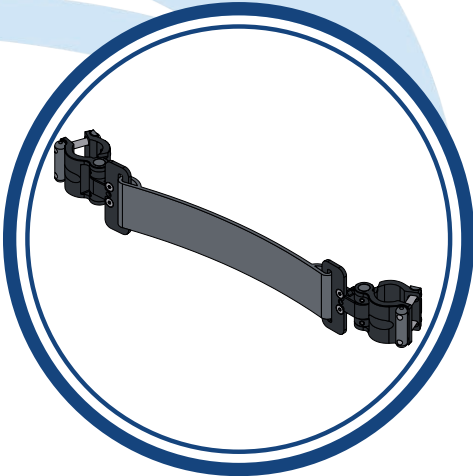

LUMBAR STRAP

This positioning aid provides additional support to the lower back in cases of lordosis or anterior pelvic tilt.

TECHNICAL SPECIFICATIONS	
Product code	D3865
Composition	1"-thick urethane cushion and nylon strap
Width	8"
Height	4"

TENSION BAR

**Standard tension bar** : This mechanism is used to improve the solidity and stability of a tension adjustable backrest or a soft sling backrest.

**Foldable tension bar** : The foldable tension bar is equipped with a release mechanism, composed of a push-button, latch and release lever system, and is used for the installation of a headrest mounting fixture on a tension adjustable backrest or soft sling backrest.

TECHNICAL SPECIFICATIONS		
Specification	Standard	Foldable
Product code	D3895 (14"- 15") D3900 (16"- 17") D3905 (18"- 19") D3910 (20"- 21")	AT5196 (12"- 15") AT5197 (15"- 18") AT5198 (18"- 22")
Adjustment	14" to 15" 16" to 17" 18" to 19" 20" to 21"	12" to 15" 15" to 18" 18" to 22"
Installation	Inserted in back post or screwed	Inserted in back post or screwed

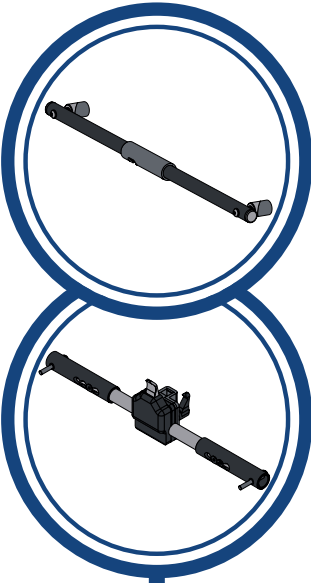





# PHYSIPRO®

Seating and mobility solutions

30 years

## Canada

370, 10th Avenue South  
Sherbrooke (Quebec) J1G 2R7  
Canada

1 800 668-2252  
[info@physipro.com](mailto:info@physipro.com)  
[www.physipro.com](http://www.physipro.com)

## Europe

Village des entrepreneurs  
461, rue Saint-Léonard  
49000 Angers  
France

02 41 69 38 01  
[contact@physipro.fr](mailto:contact@physipro.fr)