

Date :	P.O.#:
Last name:	First name:
Ordered by :	
Establishment :	
Address :	
Phone :	Fax :



CONFIRM ORDER BY E-MAIL	Yes <input type="checkbox"/>	No <input type="checkbox"/>
SUBSCRIBE TO PHYSIPRO NEWSLETTER	Yes <input type="checkbox"/>	No <input type="checkbox"/>
YOUR EMAIL ADDRESS		



Multiple postural components such as headrest, lumbar support and thoracolumbar wedge can be easily installed. The new 4 point quick release hardware system provides easy detachment for folding the wheelchair.

BACK CHOICE

D6000: Standard: 3/32" thick **\$720**

☐

D6005: Heavy Duty: 1/8" thick **\$750**

☐

COVER OPTIONS

VP1CC: Standard Cover **n/c**

☐

D5212: Lycra Black **n/c**

☐

VP1C: Extra Cover Air knit Black **\$203**

☐

D5212: Extra Cover Lycra Black **\$203**

☐

D5213: Incontinent Cover **\$90**

☐

BACK SIZE

CHOICE	BACK SIZE (W X H)	ADJUSTMENT OF THE LATERALS BACKREST	ADJUSTMENT OF THE LATERALS WHEELCHAIR CANES	ASSOCIATED CHAIR WIDTH	TYPE OF WHEELCHAIRS
<input type="checkbox"/>	10" x 10"	6.5" to 8.5"	3.5" to 11"	10" and 11"	Pediatric
<input type="checkbox"/>	10" x 12"				
<input type="checkbox"/>	12" x 12"	8.5" to 10.5"	5.5" to 13"	12" and 13"	Pediatric
<input type="checkbox"/>	12" x 14"				
<input type="checkbox"/>	14" x 14"	10.5" to 12.5"	7.5" to 15"	14" and 15"	Adult
<input type="checkbox"/>	14" x 16"				
<input type="checkbox"/>	16" x 16"	12.5" to 14.5"	9.5" to 17"	16" and 17"	Adult
<input type="checkbox"/>	16" x 18"				
<input type="checkbox"/>	16" x 20"	14.5 to 16.5"	11.5" to 19"	18" and 19"	Adult
<input type="checkbox"/>	18" x 16"				
<input type="checkbox"/>	18" x 18"	16.5" to 18.5"	13.5" to 21"	20" and 21"	Adult
<input type="checkbox"/>	18" x 20"				
<input type="checkbox"/>	20" x 16"	16.5" to 18.5"	13.5" to 21"	20" and 21"	Adult
<input type="checkbox"/>	20" x 18"				
<input type="checkbox"/>	20" x 20"	16.5" to 18.5"	13.5" to 21"	20" and 21"	Adult
<input type="checkbox"/>	20" x 20"				

CUSTOM BACKREST SIZE

CUSTOMIZATION FEE \$126

WIDTH	<input type="checkbox"/> 12"	<input type="checkbox"/> 14"	<input type="checkbox"/> 16"	<input type="checkbox"/> 18"	<input type="checkbox"/> 20"
HEIGHT	_____ "				

angle adjustment choice

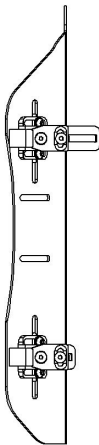

TOP	
0°	<input type="checkbox"/>
Standard 5°	<input type="checkbox"/>
10°	<input type="checkbox"/>

BOTTOM	
Standard 0°	<input type="checkbox"/>
5°	<input type="checkbox"/>
10°	<input type="checkbox"/>

mounting hardware



Fixed stabilizer

D3345 For 1" diameter tube ☐

D3346 For 7/8" diameter tube ☐

D3347 For 3/4" diameter tube ☐

cushion choice

standard foam composition

VPZ: Urethane 1 ½" (N/C) ☐vpu: custom foam overlay \$126 ☐

Additional customization fees apply in addition to the price of the foam.

Please indicate the letter (A, B, C) to determine your foam selection. *(refer to the figure)*

Choice of foam (for customization only)

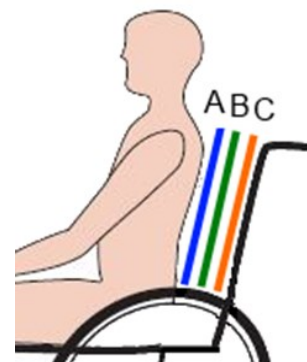
☐ VR10084C Urethane ½" \$12☐ VR10076 Urethane 1" \$18☐ VR10088 Urethane 1 ½" \$35☐ VR10074 Viscose ½" \$35☐ VR10073 Viscose 1" \$55☐ VR10085C Latex 1" \$32☐ SBS-5 Stimulite 1" \$291☐ VR10110C Sunmate soft ½" \$51☐ VR10091C Sunmate soft 1" \$87☐ VR10111C Temper T36 ½" \$95☐ VR10095C Temper T38 1" \$194

FIPS

Sunmate extra-soft ½ unit: BP-0.5U-XS \$455 ☐1 unit: BP-1U-XS \$553 ☐Sunmate soft ½ unit: BP-0.5U-S \$455 ☐1 unit: BP-1U-S \$553 ☐Sunmate medium ½ unit: BP-0.5U-M \$455 ☐1 unit: BP-1U-M \$553 ☐

Note: You must order a Lycra cover to utilize FIPS.

POSTURAL COMPONENTS

wedge

☐ D3395THORACOLUMBAR WEDGE
\$30☐ LEFT☐ RIGHT

THICKNESS

☐ 1"☐ 1 ½"☐ 2"

WIDTH: 4"

HEIGHT: determined based on the
size of the backrest☐ D3405LUMBAR WEDGE
\$24

THICKNESS

☐ 1"☐ 1 ½"☐ 2"

HEIGHT: 8"

WIDTH: determined based on the
size of the backrest☐ D3385THORACIC WEDGE
\$24

THICKNESS

☐ 1"☐ 1 ½"☐ 2"

HEIGHT: 4"

WIDTH: determined based on
the size of the backrest

lumbar support

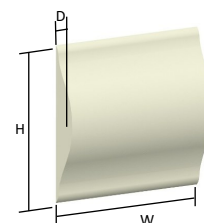
☐ #1 : D3410 L 9 ½" P: 1" H: 10" \$39☐ #2 : D3415 L 9 ½" P: 1 ½" H: 11" \$39☐ #3 : D3420 L 9 ½" P: 2" H: 12" \$39

HARDWARE OPTIONS



ADJUSTABLE

\$68 each

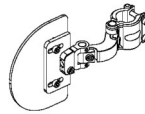

FIXED TO THE WHEELCHAIR CANE

\$144 each (fixed hardware only)
Will properly fit 3/4", 7/8" or 1"
tubing diameter.

Product #	L	Product #	R	Product #	L	Product #	R
DVRG	<input type="checkbox"/>	DVRD	<input type="checkbox"/>	DVMG	<input type="checkbox"/>	DVMD	<input type="checkbox"/>

PAD OPTIONS

STRAIGHT

\$92 each

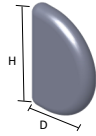

Product #	L	size	R	Product #	Adjustment
DV001G	<input type="checkbox"/>	4" H x 4" D	<input type="checkbox"/>	DV001D	Pediatric Small
DV002G	<input type="checkbox"/>	6" H x 4 ½" D	<input type="checkbox"/>	DV002D	1 ½" adjustable in height
DV003G	<input type="checkbox"/>	7" H x 4 ½" D	<input type="checkbox"/>	DV003D	1 ½" adjustable in height
DV004G	<input type="checkbox"/>	8" H x 4 ½" D	<input type="checkbox"/>	DV004D	2 ½" adjustable in height
DV005G	<input type="checkbox"/>	8" H x 5 ½" D	<input type="checkbox"/>	DV005D	2 ½" adjustable in height
DV006G	<input type="checkbox"/>	10" H x 4 ½" D	<input type="checkbox"/>	DV006D	2 ½" adjustable in height
DV007G	<input type="checkbox"/>	10" H x 5 ½" D	<input type="checkbox"/>	DV007D	2 ½" adjustable in height

CUSTOMIZATION \$126 please indicate your measurements

DVTG	L		R	DVTD	
------	---	--	---	------	--

PROFIED

\$92 each

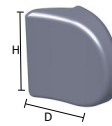

Product #	L	size	R	Product #	Adjustment
DVP001G	<input type="checkbox"/>	4" H x 4" D	<input type="checkbox"/>	DVP001D	n/a
DVP002G	<input type="checkbox"/>	6" H x 4 ½" D	<input type="checkbox"/>	DVP002D	1 ½" adjustable in height
DVP003G	<input type="checkbox"/>	7" H x 4 ½" D	<input type="checkbox"/>	DVP003D	1 ½" adjustable in height
DVP004G	<input type="checkbox"/>	8" H x 4 ½" D	<input type="checkbox"/>	DVP004D	2 ½" adjustable in height
DVP005G	<input type="checkbox"/>	8" H x 5 ½" D	<input type="checkbox"/>	DVP005D	2 ½" adjustable in height
DVP006G	<input type="checkbox"/>	10" H x 4 ½" D	<input type="checkbox"/>	DVP006D	2 ½" adjustable in height
DVP007G	<input type="checkbox"/>	10" H x 5 ½" D	<input type="checkbox"/>	DVP007D	2 ½" adjustable in height

CUSTOMIZATION \$126 please indicate your measurements

DVTG	L		R	DVTD	
------	---	--	---	------	--

HEADREST SUPPORT AND PAD

☐ STRAIGHT
AT5115
\$187

PAD STANDARD



220\$

☐ OFFSET
\$209
ADJUSTABLE LATERAL
HEADREST PAD

326\$

☐ SYMBIO
\$313
ADULT
AT5450 ☐PEDIATRIC
AT5455 ☐

- ☐ AT5000: 7" x 4"
☐ AT5005: 8" x 5"
☐ AT5010: 9" x 6"

PAD

- ☐ AT5060: 5" x 4 ½"
☐ AT5070: 6" x 5 ½"

LATERAL EXTENSIONS

- 3 ½" x 5"
 4" x 6"

Notes